



PROUDLY PURSUING
LEED
CERTIFICATION

SEPA
APPROVED
& PERMIT
READY
AVAILABLE
FOR BTS
LEASE/SALE



180th STREET LOGISTICS CENTER

121,156 SF AVAILABLE

5910 S. 180th Street, Tukwila, WA 98188

www.idilogistics.com

 **IDI Logistics**

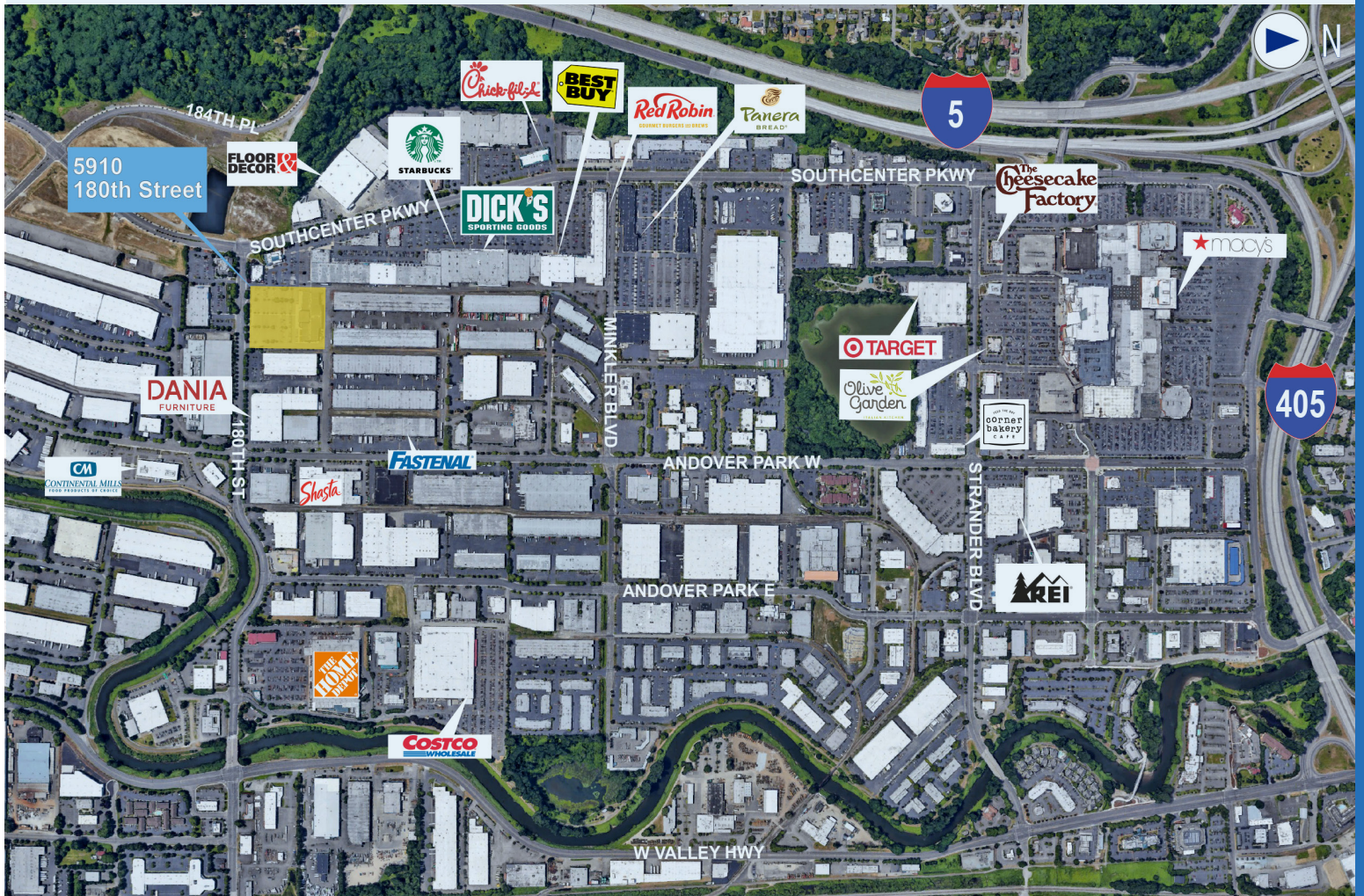

180th Street Logistics Center is a brand-new 121,156 SF Class A industrial/distribution facility strategically located at the junction of I-5 and I-405, only 4 miles to SeaTac Airport and 10 miles to the Port of Seattle.



SITE BENEFITS

- Fully entitled up to 121,156 SF
- Zoning: Tukwila Urban Center-WorkPlace
- Building design flexibility
- Abundant labor force
- Close proximity to amenities
- Controlled LED exterior lighting
- Energy efficient building
- Ability to secure
- Prominent street visibility
- Excellent transportation infrastructure
- High profile corporate neighbors
- 15 minute drive to Port of Seattle
- Strategically located at the junction of I-5 & I-405

121,156 available square feet

Available for BTS Lease/Sale
Occupancy within 12 months

SITE AREA: 5.44 acres

TOTAL OFFICE AREA: 12,000 SF

1st FLOOR OFFICE: 6,000 SF

2nd FLOOR OFFICE: 6,000 SF

CLEAR HEIGHT:	36'
BUILDING DIMENSIONS:	456' x 288'-2"
COLUMN SPACING:	52' x 60'
DOCKS:	15
DRIVE-IN DOORS:	2
TRUCK COURT:	130'
AUTO PARKING:	98 spaces
WAREHOUSE LIGHTING:	LED
POWER:	2,000 amp
FLOOR SLAB:	6"
FIRE SPRINKLER:	ESFR

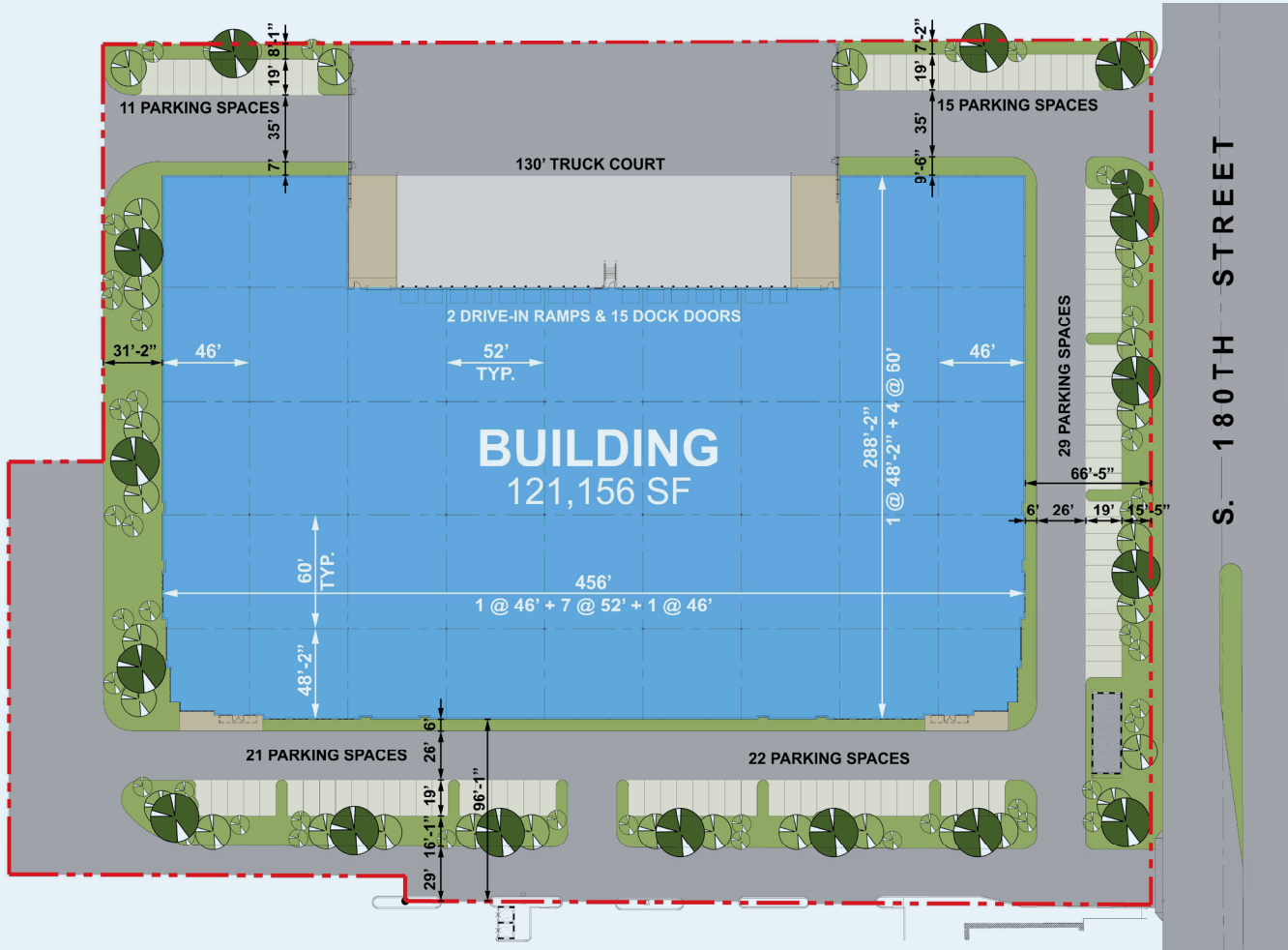

DRIVING DISTANCES

METRO AREAS

Seattle	13 miles
Tacoma.....	23 miles
Olympia.....	50 miles
Portland	164 miles

INTERSTATE

SR-167	2 miles
I-5	2.5 miles
I-405	4.7 miles
SR-509	4.9 miles

AIR

Seattle-Tacoma Int'l Airport.....4 miles

PORT

Port of Seattle.....	10 miles
Port of Tacoma	20 miles

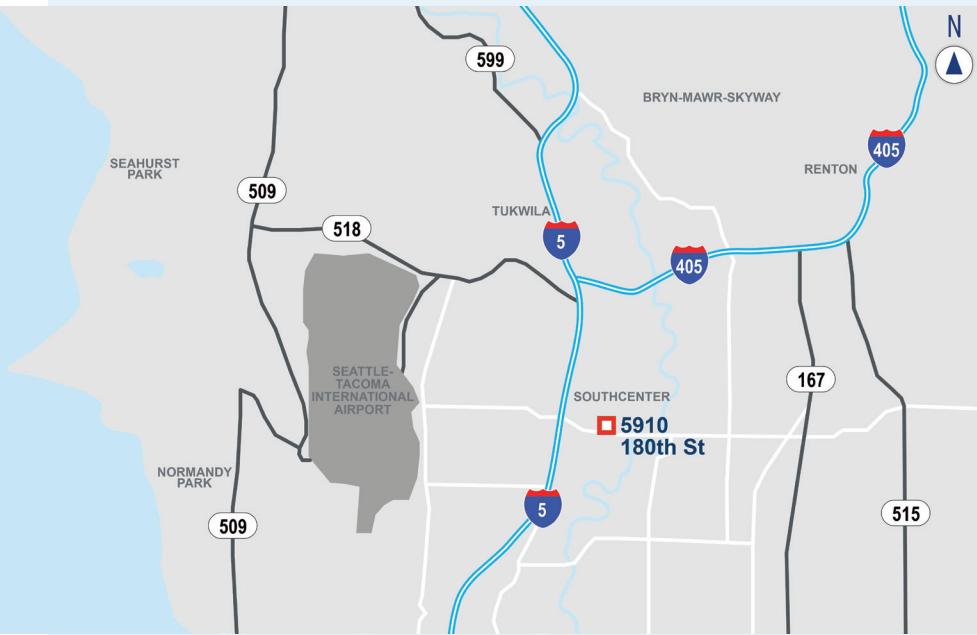

For more information, or to set up a tour, please contact:

Wilma Warshak, SIOR
 +1.206.409.1432
 wilma.warshak@wa-rea.com

Jackson Peterson
 +1.206.838.5492
 jackson.peterson@wa-rea.com

Alana Pennington Garrett
 +1.206.838.5492
 alana.pennington@wa-rea.com

Charlie McPhee
 +1.213.334.4801
 charlie.mcphee@idilogistics.com

Brandon Dickens
 +1.213.334.4805
 brandon.dickens@idilogistics.com



www.idilogistics.com

