



PROUDLY PURSUING  
**LEED**  
CERTIFICATION

**MODERN  
BULK  
WAREHOUSE  
AVAILABLE  
Q2 2024**



# 18th STREET LOGISTICS CENTER

**121,156 SF AVAILABLE**

**5910 S. 180th Street, Tukwila, WA 98188**

[www.idilogistics.com](http://www.idilogistics.com)

 **IDI Logistics**





180th Street Logistics Center is a brand-new 121,156 SF Class A industrial/distribution facility strategically located at the junction of I-5 and I-405, only 4 miles to SeaTac Airport and 10 miles to the Port of Seattle.



#### SITE BENEFITS

- Zoning: Tukwila Urban Center-WorkPlace
- Abundant labor force
- Close proximity to amenities
- Controlled LED exterior lighting
- Energy efficient building
- Ability to secure
- Prominent street visibility
- Excellent transportation infrastructure
- High profile corporate neighbors
- 15 minute drive to Port of Seattle
- Strategically located at the junction of I-5 & I-405



# 121,156

available  
square  
feet

SITE AREA: 5.44 acres

TOTAL OFFICE AREA: 12,000 SF

1st FLOOR OFFICE: 6,000 SF

2nd FLOOR OFFICE: 6,000 SF

## Ideal for Local and Regional Distribution

CLEAR HEIGHT: 32'

BUILDING DIMENSIONS: 456' x 288'-2"

COLUMN SPACING: 52' x 60'

DOCKS: 15

DRIVE-IN DOORS: 2

TRUCK COURT: 130'

AUTO PARKING: 98 spaces

WAREHOUSE LIGHTING: LED

POWER: 2,000 amp

FLOOR SLAB: 6"

FIRE SPRINKLER: ESFR

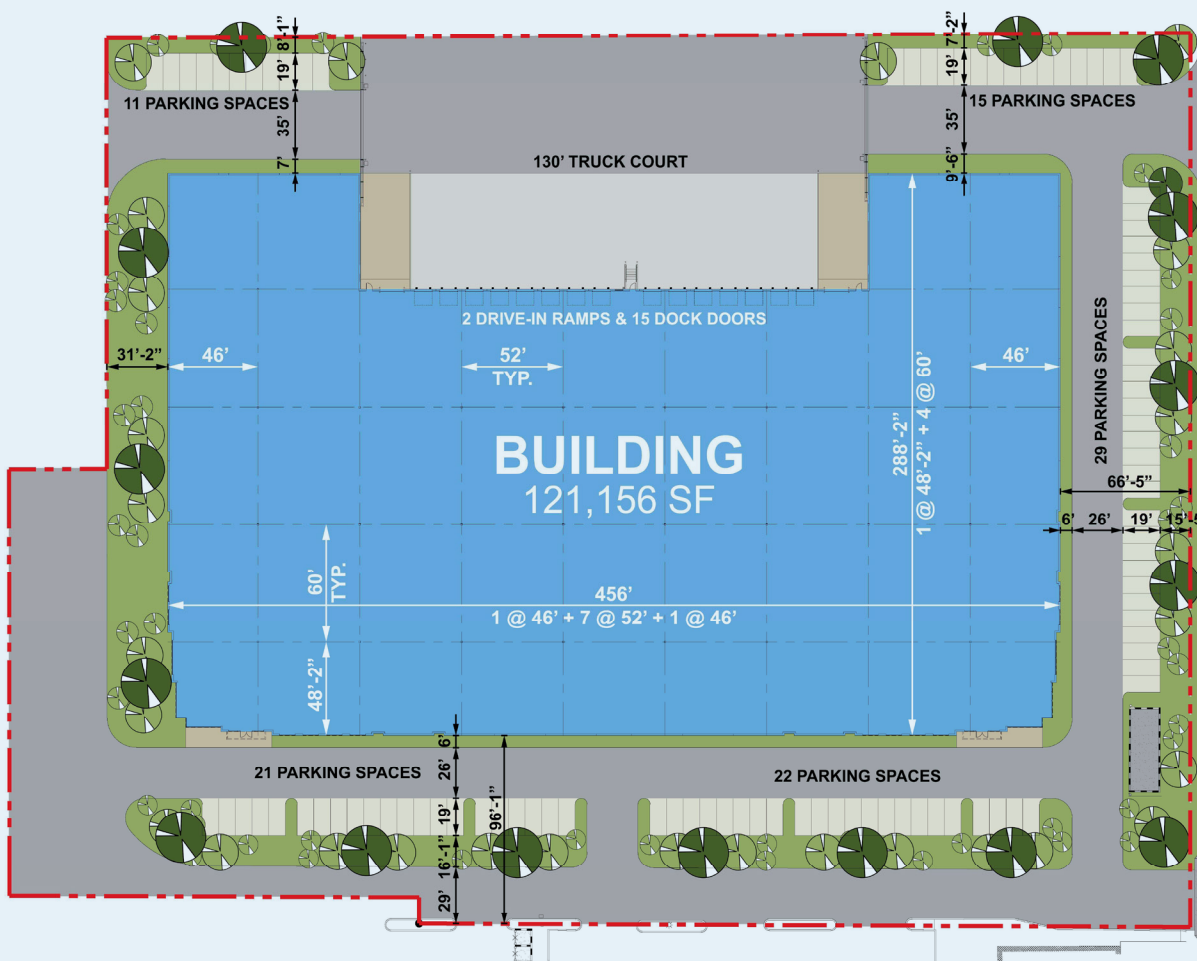

# DRIVING DISTANCES

## METRO AREAS

Seattle .....	13 miles
Tacoma .....	23 miles
Olympia .....	50 miles
Portland .....	164 miles

## INTERSTATE

SR-167 .....	2 miles
I-5 .....	2.5 miles
I-405 .....	4.7 miles
SR-509 .....	4.9 miles

## AIR

Seattle-Tacoma Int'l Airport .....4 miles

## PORT

Port of Seattle .....	10 miles
Port of Tacoma .....	20 miles

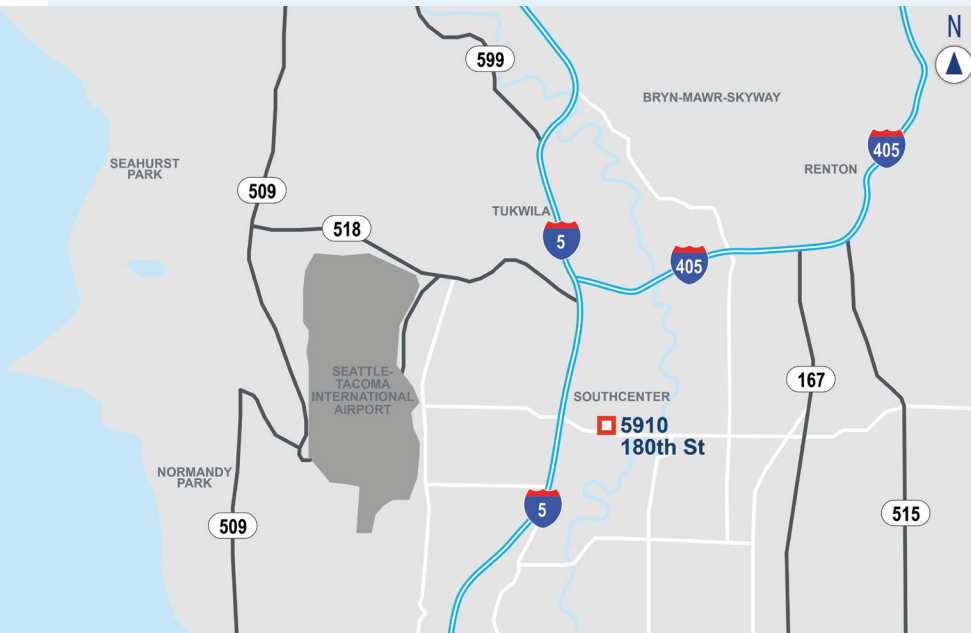

For more information, or to set up a tour, please contact:

**Wilma Warshak, SIOR**  
+1.206.409.1432  
wilma.warshak@wa-rea.com

**Jackson Peterson**  
+1.206.838.5492  
jackson.peterson@wa-rea.com

**Alana Pennington Garrett**  
+1.206.838.5492  
alana.pennington@wa-rea.com

**Charlie McPhee**  
+1.213.334.4801  
charlie.mcphee@idilogistics.com

**Brandon Dickens**  
+1.213.334.4805  
brandon.dickens@idilogistics.com



[www.idilogistics.com](http://www.idilogistics.com)

© 2023 IDI Logistics LLC. All right reserved. IDI Logistics and design are registered trademarks of IDI Logistics LLC.

