



**COMING  
SOON!**  
**1,001,424 SF  
Class A  
Distribution  
Center**

**CLICK  
HERE!**  
View  
Marketing  
Video

**CLICK  
HERE!**  
View  
Virtual Tour

*Best viewed in Microsoft Edge or Google Chrome.*



# GRAVEL SPRINGS LOGISTICS CENTER

2630 Gravel Springs Road, Buford, GA 30519

1,001,424 SF Available

[www.idilogistics.com](http://www.idilogistics.com)

 **IDI Logistics**





Gravel Springs Logistics Center is a 1,001,424 square foot Class A distribution center with direct access to Gravel Springs Road and superior access to the new Interstate 85 interchange. As the best location for bulk in the metro Atlanta area, this location offers unparalleled access to the market's abundant and highly motivated labor force, as well as excellent access to both local and regional distribution.



## 4,860 SF SPEC OFFICE PLAN

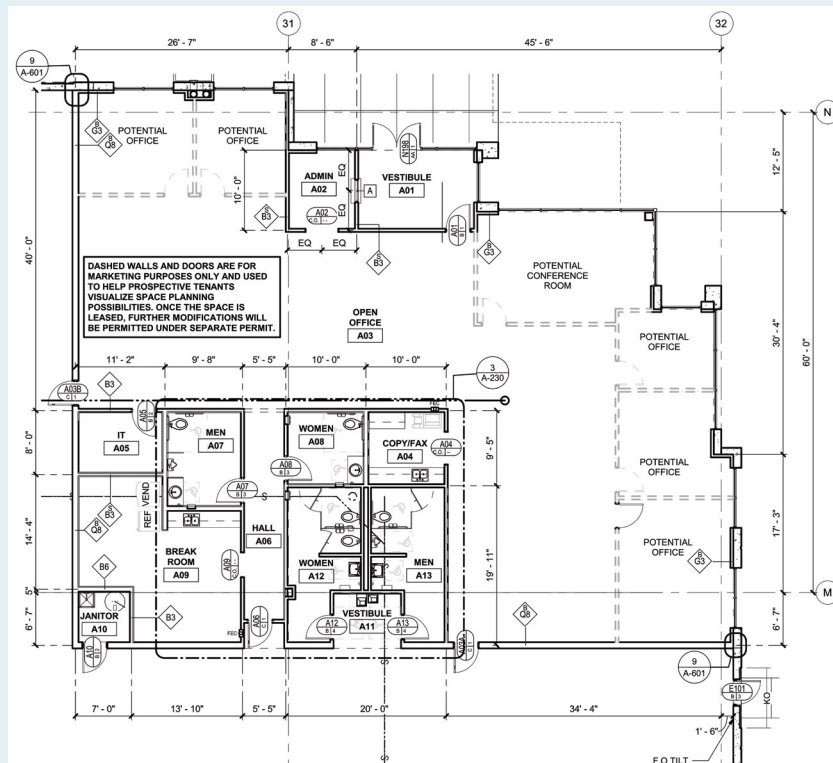



1,001,424 available square feet

IDEAL LOCATION FOR BULK IN METRO ATLANTA

SUPERIOR ACCESS TO MAJOR TRANSPORTATION ARTERIES

DIRECT ACCESS TO GRAVEL SPRINGS RD

0.2 MILES TO I-85

HIGHLY MOTIVATED, PRODUCTION-ORIENTED LABOR FORCE

CONVENIENT AMENITIES

## COMING SOON! CLASS A DISTRIBUTION CENTER IN BUFORD, GA

BUILDING TYPE:	Cross Dock
CLEAR HEIGHT:	40' Clear at first column line
AUTO PARKING:	383 spaces
TRAILER PARKING:	185 spaces
DOCK DOORS:	176 Loading Docks (9' W x 10' H) 4 Drive-In Doors (14' W x 16' H)
BUILDING DIMENSIONS:	600' D x 1674' W
TYPICAL BAY SIZE:	48' D x 54' W
STAGING BAY SIZE:	60' D x 54' W
TRUCK COURT:	185'
FIRE SPRINKLER:	ESFR system with K-25 heads at 50 PSI
FLOOR SYSTEM:	6" Ductilcrete™ slabs with sawcut joints at column lines.
ROOF SYSTEM:	60 MIL, mechanically attached, white TPO roof system with R-20 insulation in two layers. 20-Year Warranty.

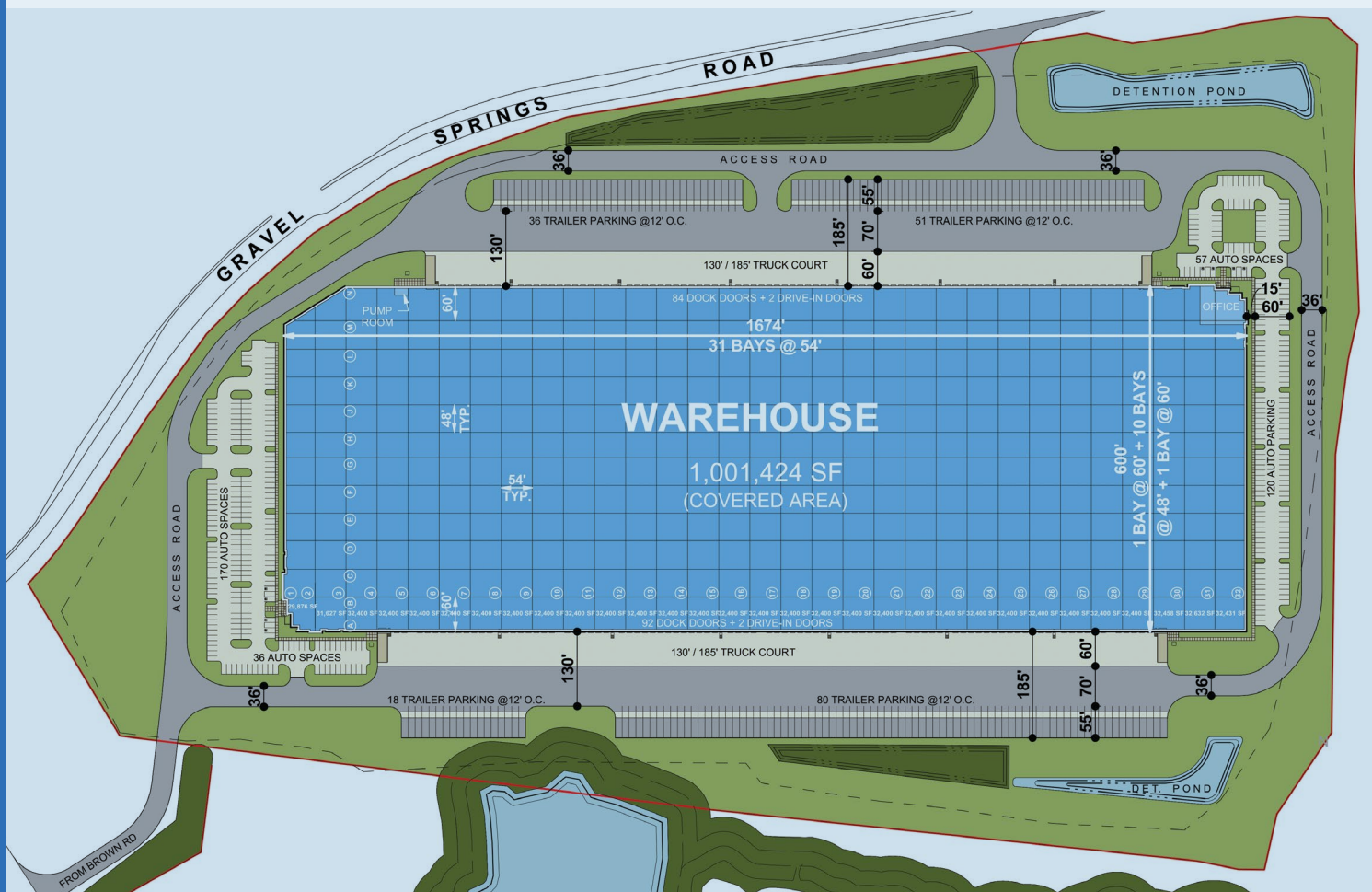



## DRIVING DISTANCES

### AIR

Peachtree Dekalb Airport .....	26 miles
Hartsfield-Jackson Int'l Airport ...	45 miles

### INTERMODAL

Norfolk Southern / Inman .....	38 miles
CSX / Atlanta (Hulsey) .....	38 miles
Norfolk Southern / Austell .....	51 miles
CSX / Fairburn .....	59 miles

### PORTS

Savannah, GA .....	283 miles
Charleston, SC .....	318 miles
Jacksonville, FL .....	383 miles
Norfolk, VA .....	532 miles
Miami, FL .....	698 miles

### GROUND

FedEx Facility .....	6.4 miles
----------------------	-----------

Located less than one quarter mile west of the brand new I-85 interchange, Gravel Springs Logistics Center is the best location providing excellent access to an unparalleled level of exposure and ease of access for a large distribution user.



For more information, or to set up a tour, please contact:

**NAI** Brannen Goddard

**Nathan Anderson**  
+1.404.812.4020  
nanderson@naibg.com

**Darren Butler**  
+1.404.812.4021  
dbutler@naibg.com

**Nick Faber**  
+1.404.479.1642  
nick.faber@idilogistics.com