



# 1600 GREAT SOUTHWEST

298,506 SF AVAILABLE

1600 S Great Southwest Parkway, Grand Prairie, TX 75051

[www.idilogistics.com](http://www.idilogistics.com)

 **IDI Logistics**





**1600 Great Southwest is a rare, high-quality in-fill site equidistant from both Dallas and Ft. Worth. The site couples great access to SH 360, I-20 & I-30 with IDI Logistics' flexible, state-of-the-art building design, providing a great option for manufacturing, distribution or E-commerce uses.**



## ABOUT IDI LOGISTICS

IDI Logistics is a leading developer and manager of logistics real estate in the U.S. Our fully-integrated logistics platform has a long track record of speculative development, build-to-suits and value-add acquisitions.

We are dedicated to serving our customers with exceptional quality and service.



**298,506** available square feet

DIVISIBLE TO: 149,253 SF

OFFICE AREA: 2,414 SF

CLEAR HEIGHT: 36'

**SPEC OFFICE**  
**2,414 SF**

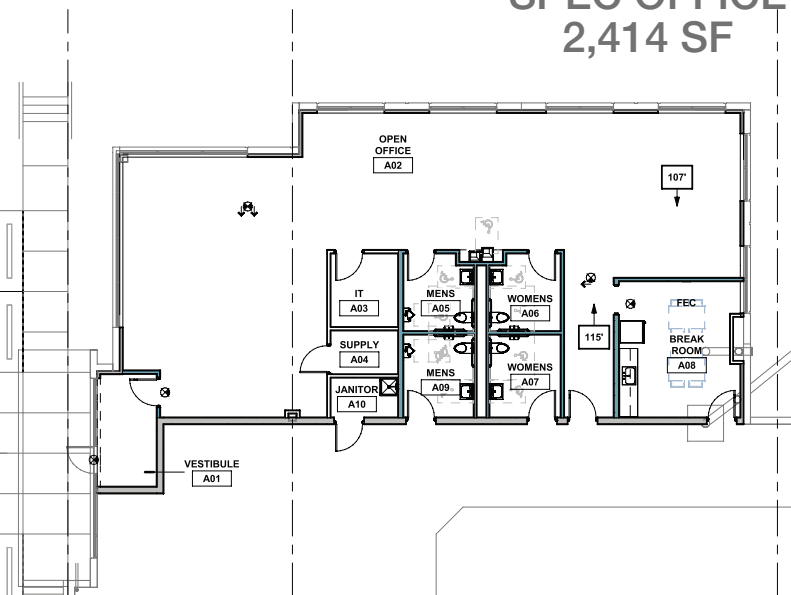

## Class A Distribution, Warehouse & Manufacturing Space

**DOCKS:** 49 (9' x 10')

**DRIVE-IN DOORS:** 2 (14' x 16')

TRUCK COURT: 130' / 185'

**AUTO PARKING:** 133 spaces

**TRAILER PARKING:** 71 stalls

**COLUMN SPACING:** 54' x 50'

**FIRE SPRINKLER:** ESFR

**LIGHTING:** High bay LED lights with motion sensors

**LEED® SILVER CERTIFIED**

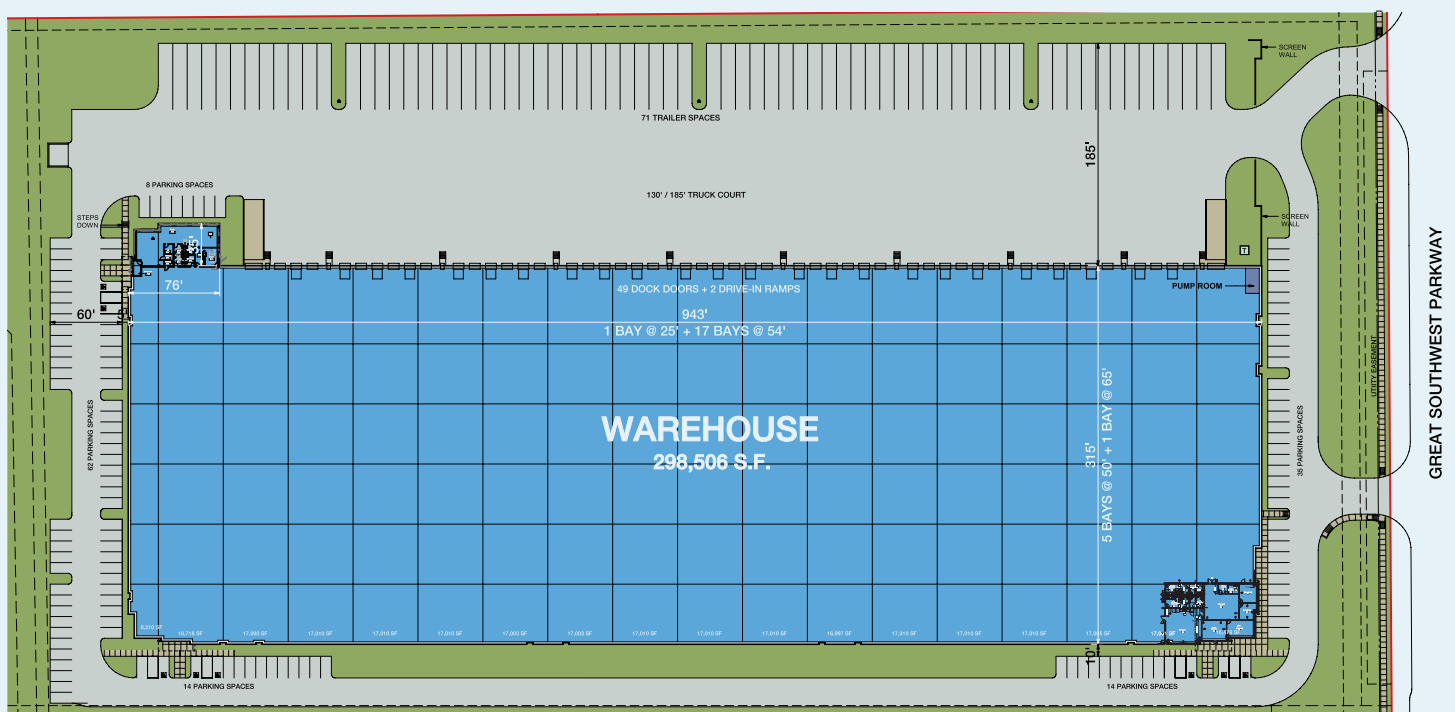



## DRIVING DISTANCES



## METRO AREAS

Arlington.....	4.8 miles
Downtown Dallas.....	18 miles
Fort Worth.....	22 miles
Austin .....	200 miles
Oklahoma City .....	210 miles

## MAJOR ROADS

I-30 .....	4.4 miles
I-20 .....	4.4 miles
I-820 .....	15 miles
I-635 .....	17 miles

## AIR

DFW Airport .....13 miles  
Dallas Love Field Airport.....21 miles

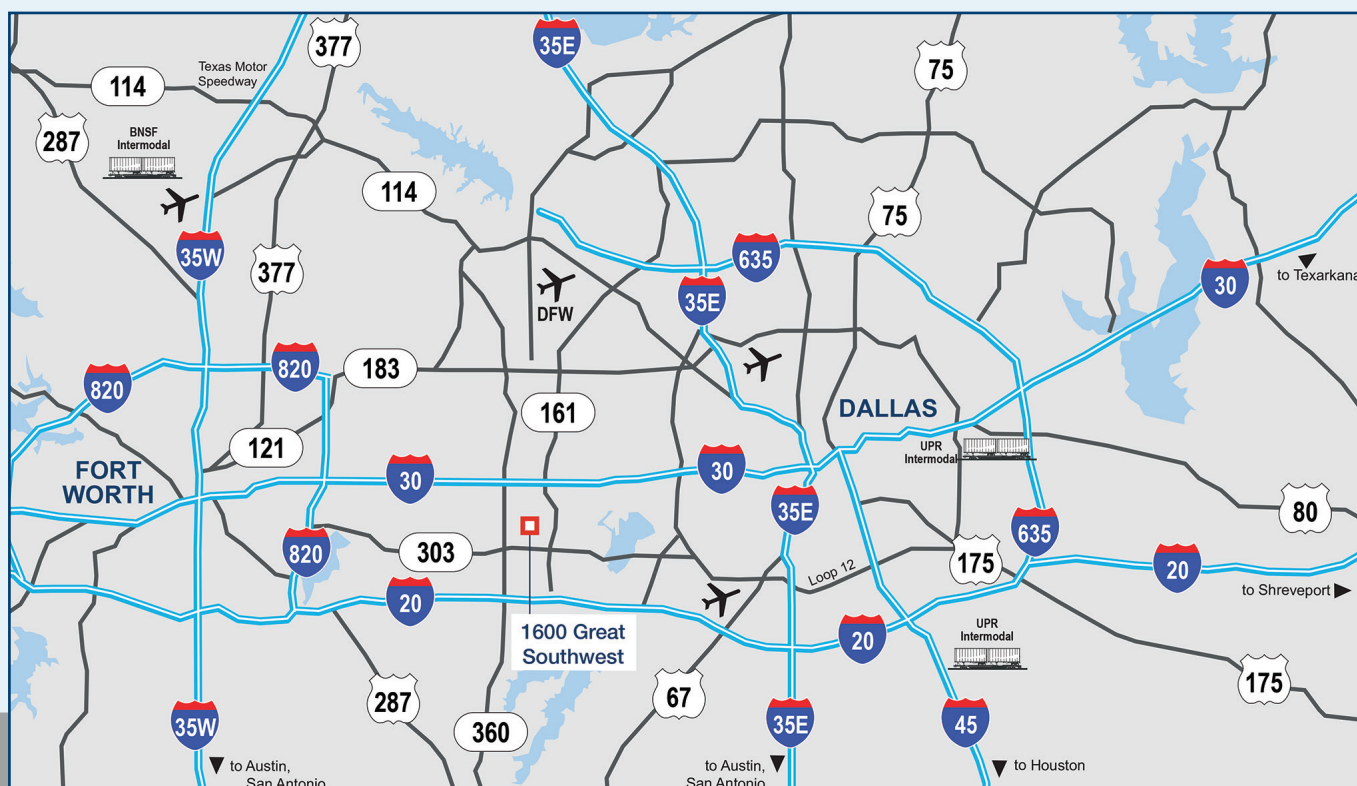

For more information, or to set up a tour, please contact:



**Rick Medinis, SIOR**  
+1.214.256.7116  
rmedinis@nairl.com

**Tyson Erwin, SIOR**  
+1.214.256.7127  
terwin@nairl.com

**Brian Denning**  
+1.214.256.7184  
bdenning@nairl.com

**Jon Harmon**  
+1.972.560.7001  
jon.harmon@idilogistics.com

**Tony Maclin**  
+1.972.560.7009  
tony.maclin@idilogistics.com

[www.idilogistics.com](http://www.idilogistics.com)

© 2023 IDI Logistics LLC. All right reserved. IDI Logistics and design are registered trademarks of IDI Logistics LLC.

